



Instinct Guides You



## Glendinning Avenue, Weymouth £160,000

- No Onward Chain
- Two Double Bedrooms
- Spacious Dual Aspect Lounge/Diner With
- Off Road Parking
- Close To Town Centre & Lodmoor Hill
- Easy Access To Bus Route
- Long Lease - Share Of Freehold



Registration No. 08079158 Directors Mr Wilson, Mr Tominey

Courtesy Notice Upon using WilsonTominey as selling agents ensure we are made aware of contractual obligations you may be under. We can then proceed accordingly.

WilsonTominey Ltd  
15 Westham Rd.  
DT4 8NS

T 01305 775500  
E sales@wilsontominey.co.uk  
W www.wilsontominey.co.uk



Wilson Tominey are delighted to present this well-maintained two double bedroom apartment with allocated parking, ideally situated just a short distance from the town centre and its wide range of amenities.

Located on the first floor and accessed via a communal staircase, the property opens into a generous hallway that provides access to all rooms. The heart of the home is the spacious lounge/dining room, offering ample space for a variety of furnishings and enjoying a bright dual aspect, enhanced by an attractive bay window.

Adjacent sits the well-appointed kitchen, fitted with a range of cabinetry and space for appliances. A charming angular bay window adds character and natural light to the space.

Both bedrooms are well-proportioned doubles, offering excellent versatility for those needing guest accommodation, a home office, or additional storage. The bathroom completes the apartment, featuring a modern white suite set against contemporary tiling.

Location - The property sits within easy reach of Weymouths vibrant town center & picturesque Harbourside. The train station servicing direct link to London Waterloo is within close proximity.



**Living/Dining Room 14'11" max x 12'11" max (4.56 max x 3.95 max)**

**Kitchen 9'8" x 5'0" (2.96 x 1.53)**

**Bedroom One 12'9" max x 9'3" max (3.90 max x 2.84 max )**

**Bedroom Two 12'9" max x 11'4" max (3.90 max x 3.46 max )**

**Bathroom 8'1" x 4'8" (2.47 x 1.43)**

**Lease & Maintenance Information**

The vendor informs us that the property has a 1/10th share of freehold with a remaining lease of 965 years, there is a ground rent of £25 per annum and a monthly service charge of £95, holiday lettings and pets are permitted.

We recommend that these details are checked by a solicitor before incurring any costs.

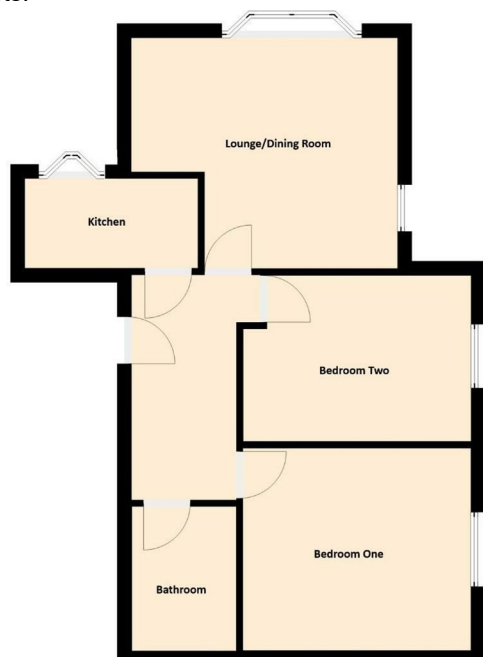

| Energy Efficiency Rating                    |  | Current                 | Potential |
|---|--|-------------------------|-----------|
| Very energy efficient - lower running costs |  |                         |           |
| (92 plus) A                                 |  |                         |           |
| (81-91) B                                   |  |                         |           |
| (69-80) C                                   |  |                         |           |
| (55-68) D                                   |  |                         |           |
| (39-54) E                                   |  |                         |           |
| (21-38) F                                   |  |                         |           |
| (1-20) G                                    |  |                         |           |
| Not energy efficient - higher running costs |  |                         |           |
| England & Wales                             |  | EU Directive 2002/91/EC |           |

| Environmental Impact (CO <sub>2</sub> ) Rating                  |  | Current                 | Potential |
|---|--|-------------------------|-----------|
| Very environmentally friendly - lower CO <sub>2</sub> emissions |  |                         |           |
| (92 plus) A   |  |                         |           |
| (81-91) B   |  |                         |           |
| (69-80) C   |  |                         |           |
| (55-68) D   |  |                         |           |
| (39-54) E   |  |                         |           |
| (21-38) F   |  |                         |           |
| (1-20) G  |  |                         |           |
| Not environmentally friendly - higher CO <sub>2</sub> emissions |  |                         |           |
| England & Wales   |  | EU Directive 2002/91/EC |           |

Important Notice: Particulars are prepared for marketing purposes only and should not be treated as a statement of the condition of any building, fixture or appliance. All measurements, floor plans and lease/ maintenance are approximate and not to be relied upon. Purchasers should make their own checks before relying on any of the information provided herein. \* For double glazing and gas radiator heating, it is where specified.